

Humor Spotlight



v

An Easterner who walked into a Western saloon was amazed to see a dog sitting at a table playing poker with three men.

"Can that dog really read cards?" he asked.

"Yeah, but he ain't much of a player," said one of the men. "Whenever he gets a good hand he wags his tail."

v

Upon receiving a ticket from a state trooper, the confused motorist was heard to reply "Eighty miles an hour! I've only been driving for fifteen minutes."

v

There is nothing worse than being a mime troupe without any money for promotion...the problem is that you must rely on "word-of-mouth" advertising.

v

"Drop-dead gorgeous" usually means when you ask them out they tell you to drop dead.

SECURITY MANAGEMENT

In Hollywood, the Bad Guys Can Open Any Door With Their Credit Card

In Hollywood, when the bad guys want to break-in, they just take out their credit card, slide it between the door and the jamb and pop the latch open. While this looks good in the movies, this break-in technique has been virtually eliminated by dead latches.

What's a Deadlatch?

If your door knob has a key, chances are the latch will have two parts. The large part is the spring bolt goes into the strike and holds the door closed. The small plunger is the dead latch.

The deadlatch is designed to sit on the face of the strike when the door is closed. With the deadlatch depressed, the large plunger cannot be pushed in. Unfortunately, if your door closes too far or the strike plate opening

is too large, both pieces of the latch will spring into the strike hole and the deadlocking feature will be disabled. At this point anyone can easily jimmy the latch.

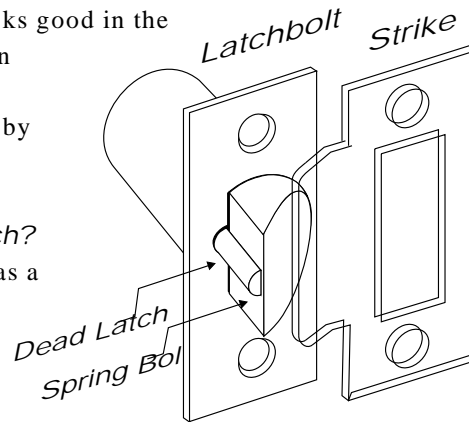

Use the "Click Test"

To make sure the latch on your door is working correctly, close the door and listen. You will hear the latch click into the strike and then if you hear a second click, it's the deadlatch springing into the strike.

How to Fix the Problem

This problem can be remedied by either replacing the strike or by replacing the silencers on the door frame. (The silencers are those little rubber bumpers used on steel door frames.) By

making sure all of your doors are latching properly, you'll keep the bad

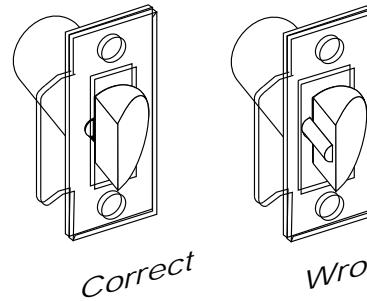

SECURITY PRODUCTS

Burglars are Looking For Easy Targets

Knobsets are an easy target for the average burglar. But by taking a few simple precautions, you can significantly reduce your risk.

Modifications Make the Difference

After you make sure all of your latch bolts are operating properly, you need to protect your latches from prying. The easiest way to do this is with a latchguard designed to cover the gap between the door and the frame.

Ask for the Latchguard with the Pin

Some latchguards also include a steel pin which is designed to seat into a hole drilled in the frame. This feature prevents prying by holding the door and jamb together. Using latchguards on your knobsets is a simple way to send the average burglar looking

